

FOREST ORDER NO. 08-22-02
MENDOCINO NATIONAL FOREST

Pursuant to 16 U.S.C § 551 and 36 C.F.R § 261.50(a), and to provide for public safety and to protect natural resources, the following acts are prohibited within the Chico Seed Orchard (CSO) of the Mendocino National Forest. These prohibitions are effective from March 14, 2022, through March 10, 2024.

1. Being within the CSO between the hours of 7:00 p.m. and 7:00 a.m. from March 1 through October 31; and between the hours of 5:00 p.m. and 7:00 a.m. from November 1 through February 29, as shown on the attached map.
36 C.F.R § 261.58(I).
2. Being within the portions of the CSO known as the Northwest Seed Production Orchard, the Northeast Seed Production Orchard, the Southwest Seed Production Orchard, the Douglas Fir Production Orchard, and the Valley Oak Provenance Study Area, as shown on the attached map.
36 C.F.R § 261.53(e).
3. Being within the CSO with an off-leash dog. 36 C.F.R § 261.58(s).

Pursuant to 36 C.F.R § 261.50(e), the following persons are exempt from this Order:

1. Persons with Forest Service Permit No. FS-7700-48 (Permit for Use of Roads, Trails, or Areas Restricted by Regulation or Order), specifically exempting them from this Order.
2. Any Federal, State, or local officer, or member of an organized search and rescue or fire fighting force in the performance of an official duty.

These prohibitions are in addition to the general prohibitions contained in 36 C.F.R § 261, Subpart A.

A violation of these prohibitions is punishable by a fine of not more than \$5,000 for an individual or \$10,000 for an organization, or imprisonment for not more than six months, or both. 16 U.S.C § 551 and 18 U.S.C § 3559, 3571, and 3581.

Done at Willows, California this 21st day of January 2022.



ANN D. CARLSON
Forest Supervisor
Mendocino National Forest

ORDER NO. 08-22-02 MENDOCINO NATIONAL FOREST CHICO SEED ORCHARD

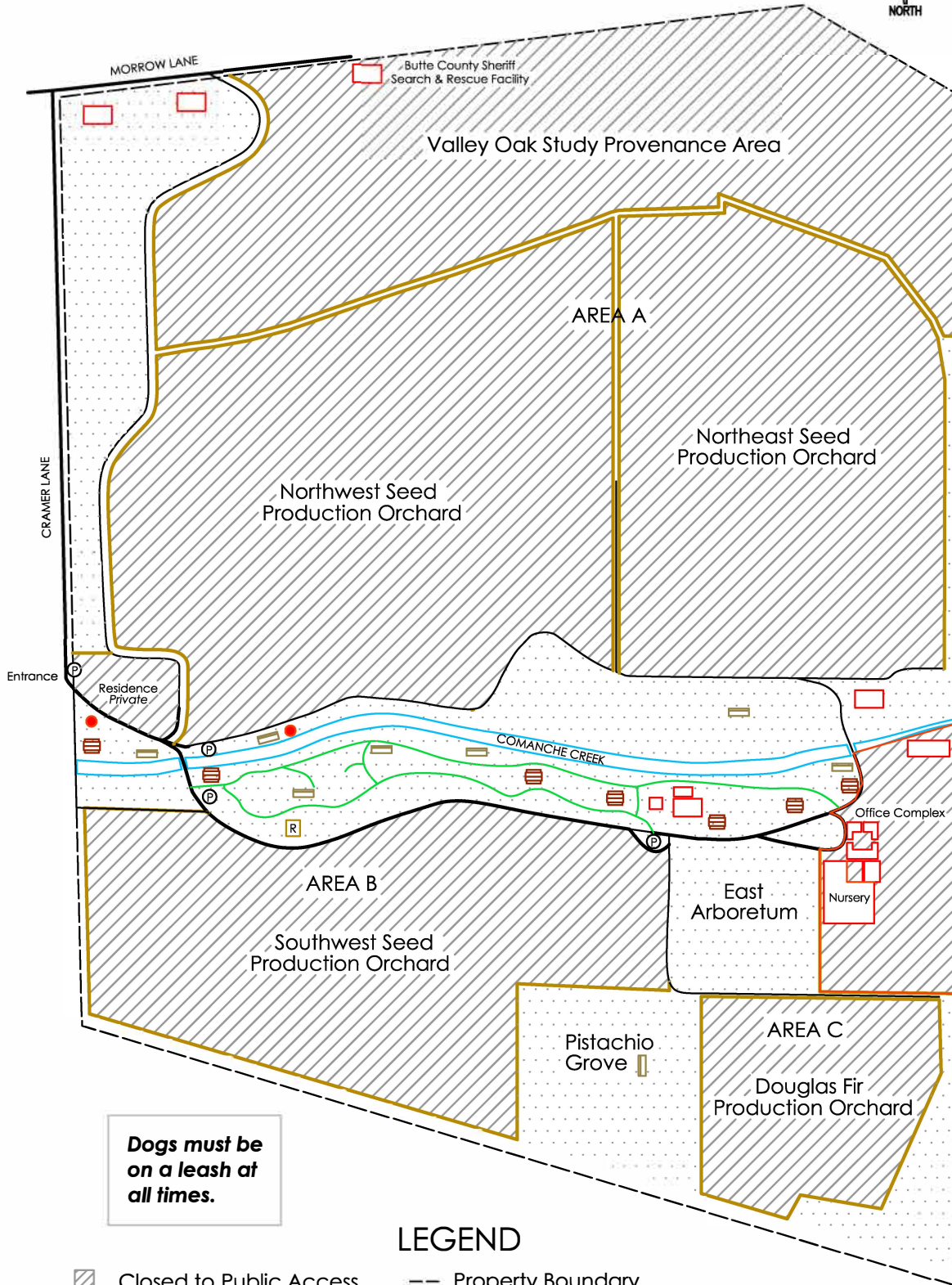

Dogs must be on a leash at all times.

LEGEND

- | | | |
|--|--------------------|--------------|
| Closed to Public Access | Property Boundary | Building |
| Open Public Area
(MAR 1st - OCT 31st; 7 AM - 7 PM)
(NOV 1st - FEB 29th; 7 AM - 5 PM) | Paved Nature Trail | Picnic Table |
| Paved Road | Parking | Restroom |
| Service Road | Dog Waste Station | Bench |